



Abrir cuenta de Canvas como Observador

Siga estas instrucciones para crear una cuenta de Canvas que le permitirá ver las tareas de su estudiante, comunicarse con su maestro y revisar las calificaciones, ¡todo en un solo lugar!

Pídale a su estudiante que inicie sesión en su cuenta.

1. A continuación, haz clic en Cuenta y selecciona Configuración.

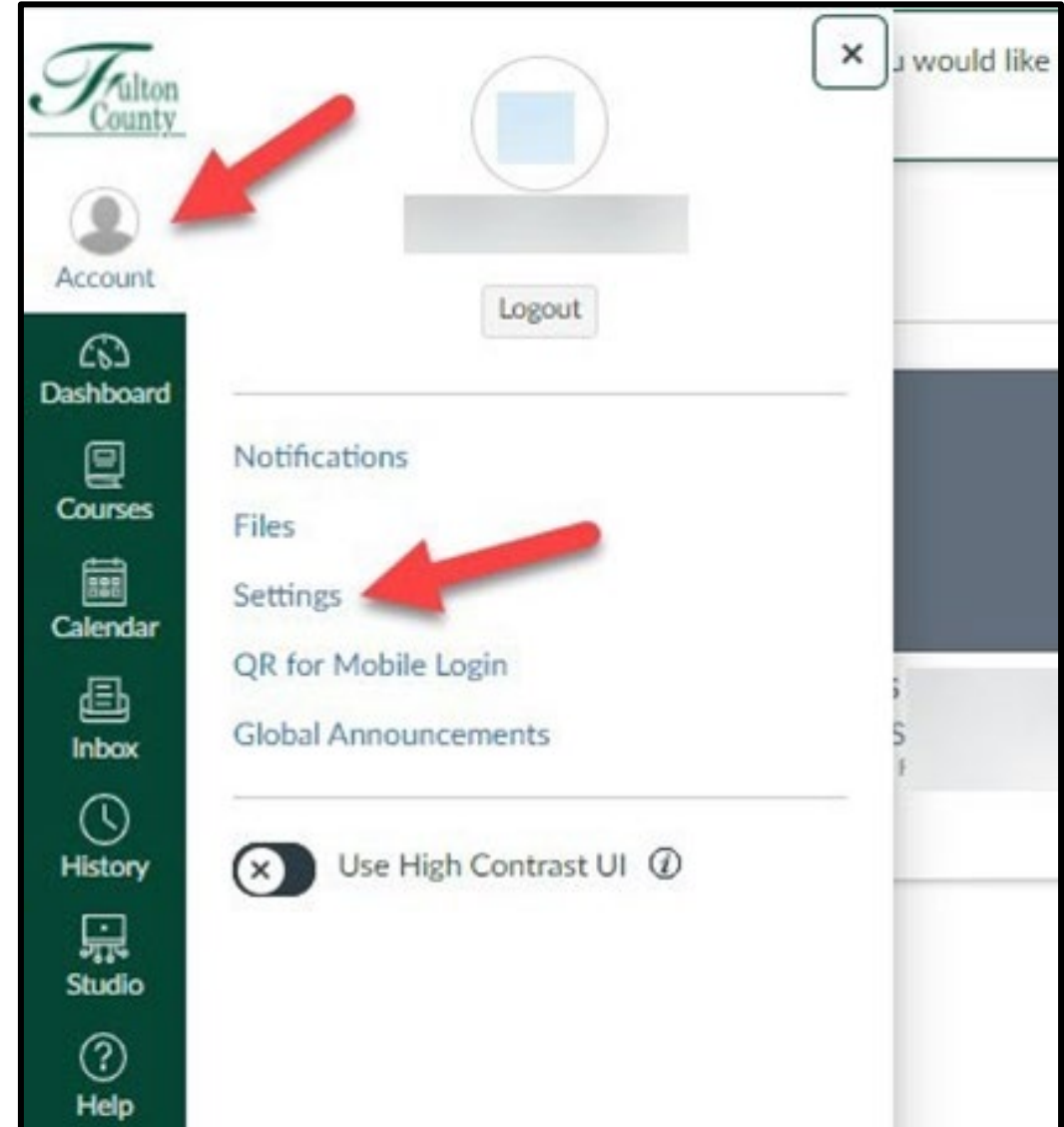

Families

Familias 

Haga clic en Emparejar con observador en el lado derecho.

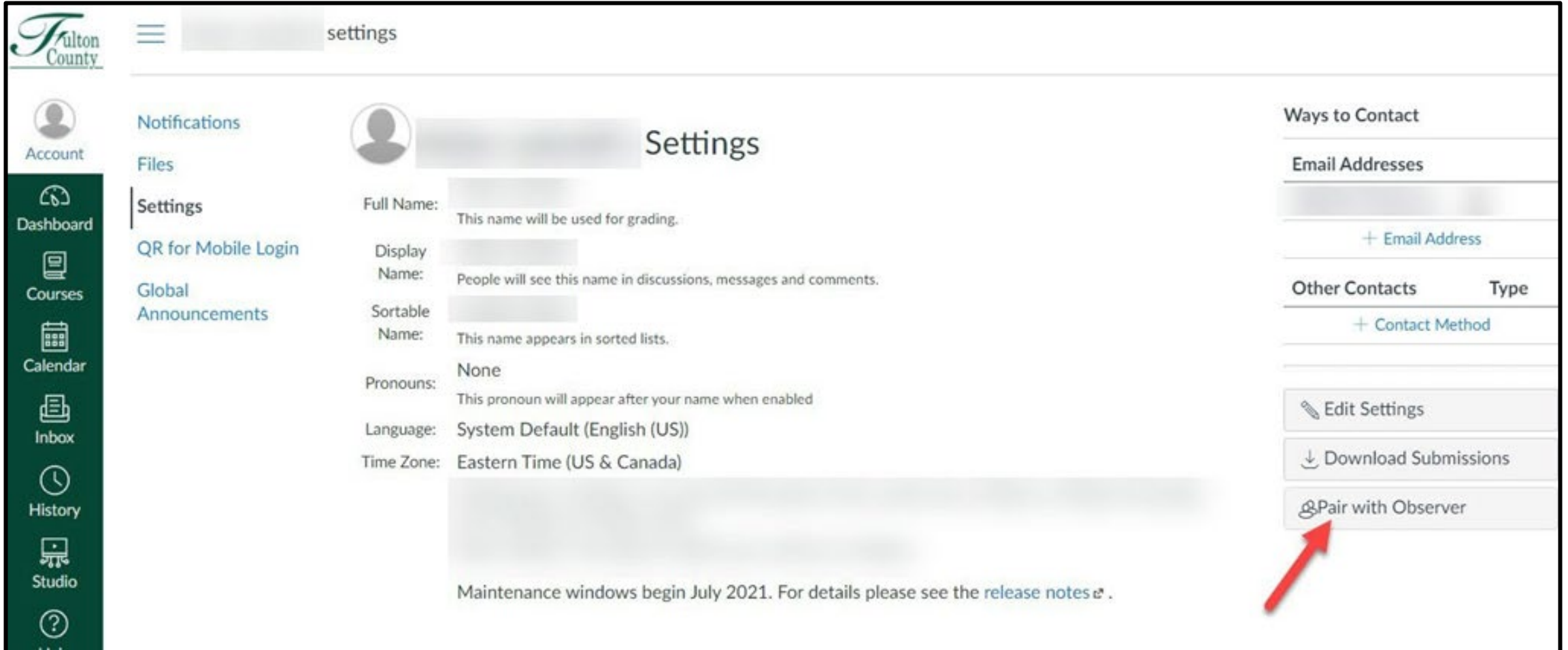

The screenshot shows the 'Settings' page for a user in the Fulton County system. The page is titled 'settings' and features a sidebar with navigation options: Account, Dashboard, Courses, Calendar, Inbox, History, and Studio. The main content area is titled 'Settings' and includes the following fields:

- Full Name: [Redacted] (This name will be used for grading.)
- Display Name: [Redacted] (People will see this name in discussions, messages and comments.)
- Sortable Name: [Redacted] (This name appears in sorted lists.)
- Pronouns: None (This pronoun will appear after your name when enabled)
- Language: System Default (English (US))
- Time Zone: Eastern Time (US & Canada)

At the bottom of the main content area, there is a note: "Maintenance windows begin July 2021. For details please see the [release notes](#)."

On the right side of the page, there is a 'Ways to Contact' section with the following options:

- Email Addresses: [Redacted] + Email Address
- Other Contacts: [Redacted] + Contact Method

Below these options are three buttons: 'Edit Settings', 'Download Submissions', and 'Pair with Observer'. A red arrow points to the 'Pair with Observer' button.



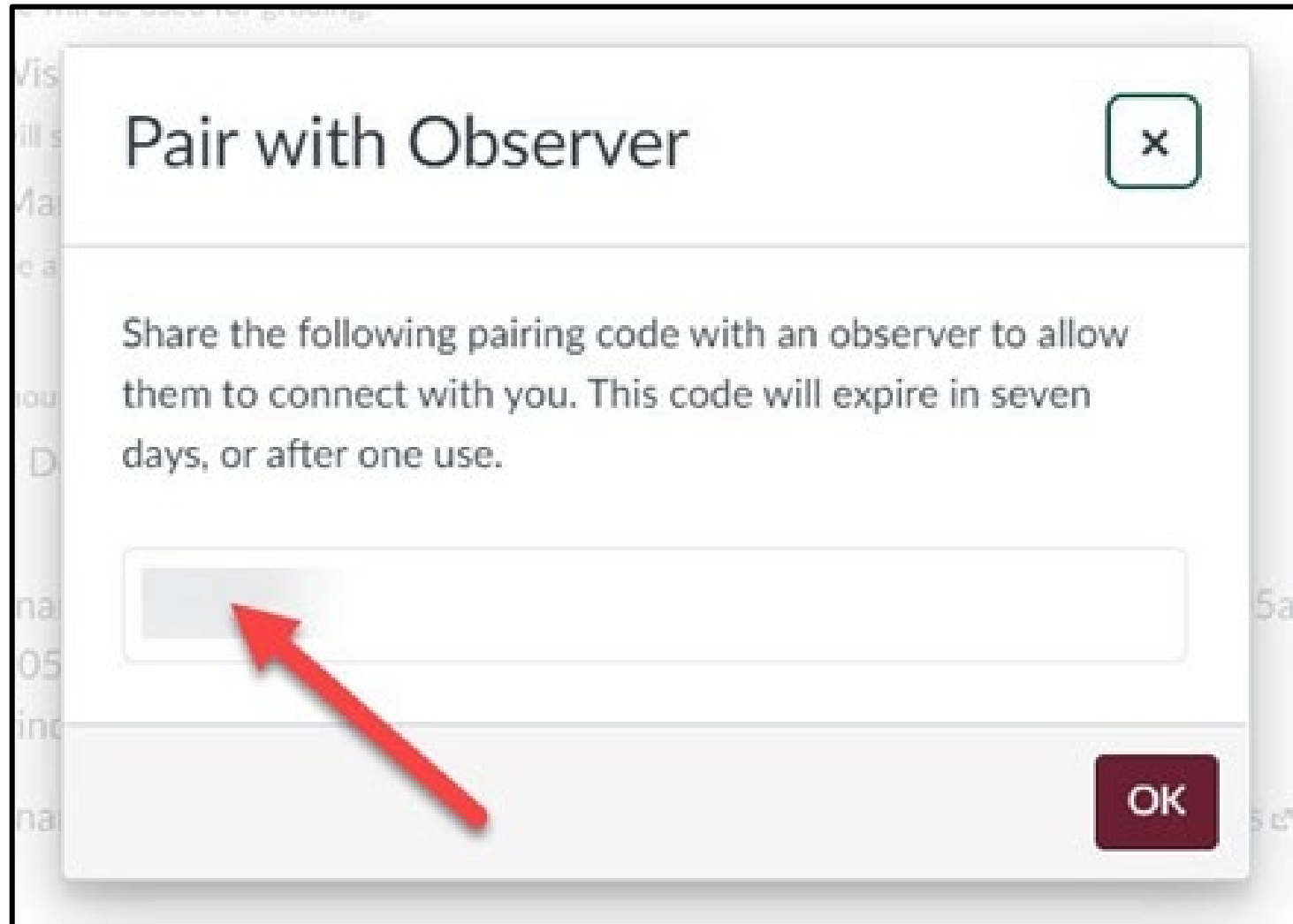

Escriba o copie el código de emparejamiento.

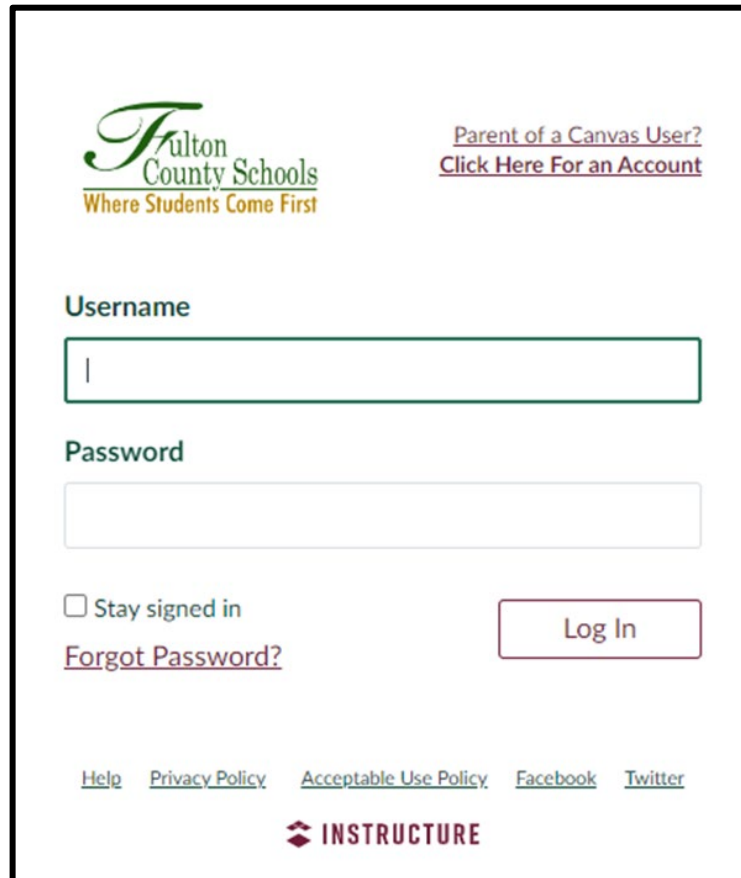

Ahora, los miembros de la familia...

1. Visitar <https://fultonschools.instructure.com/login/canvas>
2. A continuación, haga clic en Padre del usuario de Canvas.



 **Fulton County Schools**
Where Students Come First

[Parent of a Canvas User?
Click Here For an Account](#)

Username

Password

Stay signed in

[Forgot Password?](#)

[Help](#) [Privacy Policy](#) [Acceptable Use Policy](#) [Facebook](#) [Twitter](#)



Families ¡Paso final!

Familias

1. Completa el formulario con tus datos.

Aquí escribe el código que anotaste anteriormente

2. Haz clic en Empezar a participar.

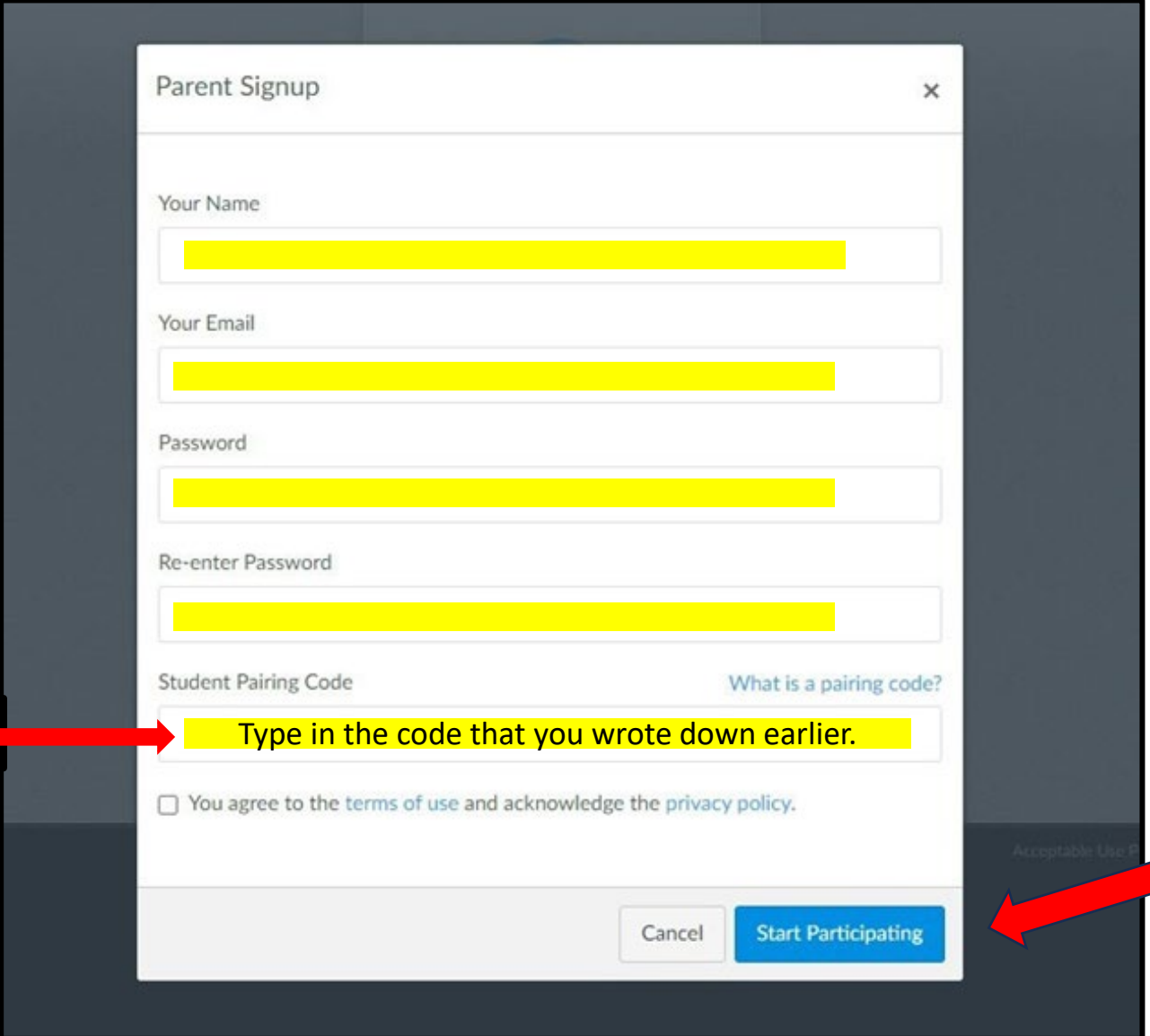

The screenshot shows a 'Parent Signup' form with the following fields: 'Your Name', 'Your Email', 'Password', 'Re-enter Password', and 'Student Pairing Code'. The 'Student Pairing Code' field contains the text 'Type in the code that you wrote down earlier.' and is highlighted with a yellow background. A red arrow points from the text 'Aquí escribe el código que anotaste anteriormente' to this field. Below the form is a checkbox labeled 'You agree to the terms of use and acknowledge the privacy policy.' and two buttons: 'Cancel' and 'Start Participating'. A red arrow points to the 'Start Participating' button. The form is set against a dark grey background.